

SERIE BS88
BS88 series | Série BS88



FUSIBILI BS88 INDUSTRIALI NITD
NITD Industrials BS88 Fuses | Fusibles Industriels BS88 NITD

Caratteristica Rapidi	Characteristic Fast	Caractéristique Rapides
Corrente 2A/32A	Current 2A/32A	Courant 2A/32A
Tensione 550 V	Voltage 550 V	Tension 550 V
Capacità di rottura 80 kA	Breaking capacity 80 kA	Pouvoir de coupure 80 kA
Corpo Ceramica	Body Ceramic	Corps Céramique
Cod. omologazione Bussmann: NITD (A1)	Approval code Bussmann: NITD (A1)	Code d'homologation Bussmann: NITD (A1)
Norme riferimento BS88.1 IEC 60269-1	Standards BS88.1 IEC 60269-1	Normes BS88.1 IEC 60269-1

pag. 140



Codice Code Code	Corrente nominale Rated current Courant nominal	I ² t I ² t Ft	Pot. dissipata Power loss Puiss. dissipée
BSNITD002	2 A	5	0,9
BSNITD004	4 A	30	1,4
BSNITD006	6 A	115	1,8
BSNITD010	10 A	490	2,1
BSNITD016	16 A	730	1,8
BSNITD020	20 A	1700	1,8
BSNITD025	25 A	3550	2,0
BSNITD032	32 A	5000	2,9

BASE PORTAFUSIBILE
Fuse base | Base porte-fusibles

Codice Code Code	Descrizione Description Description	Corrente nominale Rated current Courant nominal	Tensione Voltage Tension
BSCM32FC	Base portafusibile/Fuse base/Base porte-fusibles	32 A	660 V

Dimensioni | Dimensions | Dimensions

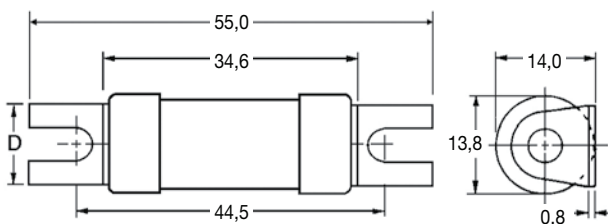

20 pz / 20 pcs / 20 pces
 pronta in stock / en stock
 su richiesta fornibile versione per motore / motor version upon request / version pour moteur fournissable sur demande

FUSIBILI BS88 INDUSTRIALI AAO
AAO Industrials BS88 Fuses | Fusibles Industriels BS88 AAO

Caratteristica Rapidi	Characteristic Fast	Caractéristique Rapides
Corrente 2A/32A	Current 2A/32A	Courant 2A/32A
Tensione 550 V	Voltage 550 V	Tension 550 V
Capacità di rottura 80 kA	Breaking capacity 80 kA	Pouvoir de coupure 80 kA
Corpo Ceramica	Body Ceramic	Corps Céramique
Cod. omologazione Bussmann: AAO (A2)	Approval code Bussmann: AAO (A2)	Code d'homologation Bussmann: AAO (A2)
Norme riferimento BS88.1 IEC 60269-1	Standards BS88.1 IEC 60269-1	Normes BS88.1 IEC 60269-1

pag. 140



Codice Code Code	Corrente nominale Rated current Courant nominal	I ² t I ² t Ft	Pot. dissipata Power loss Puiss. dissipée
BSAA0002	2 A	5	0,9
BSAA0004	4 A	30	1,4
BSAA0006	6 A	115	1,8
BSAA0010	10 A	500	2,1
BSAA0016	16 A	750	1,8
BSAA0020	20 A	1700	1,8
BSAA0025	25 A	2500	2,0
BSAA0032	32 A	5000	2,9

BASE PORTAFUSIBILE
Fuse base | Base porte-fusibles

Codice Code Code	Descrizione Description Description	Corrente nominale Rated current Courant nominal	Tensione Voltage Tension
BSCM32F	Base portafusibile/Fuse base/Base porte-fusibles	32 A	660 V

Dimensioni | Dimensions | Dimensions

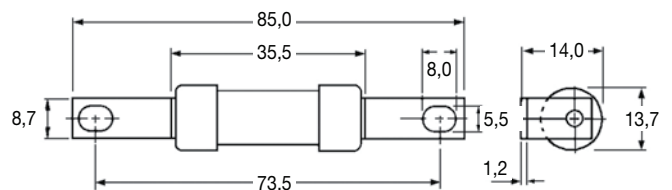

20 pz / 20 pcs / 20 pces
 pronta in stock / en stock
 su richiesta fornibile versione per motore / motor version upon request / version pour moteur fournissable sur demande