

**INTERCOM**

**WIRE TO BOARD SHROUDED HEADER**

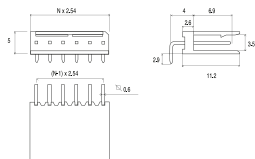

**Features** Polarized header with friction lock  
Pitch 2.54 mm

**Material** Insulator:  
Black thermoplastic GF UL 94V0  
Contact: Phosphor bronze

**Electrical** Current rating: 4 A maxi  
Dielectric withstanding  
Insulation resistance: 1000 MΩ mini

**Mechanical** Temperature rating:  
-40 °C to 125 °C

**Packaging** Recyclable cardboard boxes

**Product Code**

A	B	C	D	E	F
476	0395	1	xx	4x0	-1

**D** Number of contacts from 02 to 20

**E** Plating  
0 Gold: 0.2 μm over Ni 1.27 μm  
4 Tin 4 μm over Ni 1.27 μm  
7 Selective Gold 0.2 μm over Ni 1.27 μm  
Other platings on demand

**CT84SN**

**WIRE TO BOARD CRIMP CONTACT**

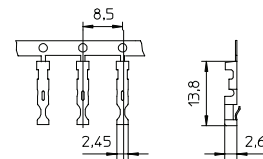

**Features** Double wipe contact use with BS95 Housing awg 30-16

**Material** Double wipe contact use with BS442 Housing

**Electrical** Current rating: 4 A

**Mechanical** Temperature rating: -30 °C to 85 °C

**Packaging** Reel 10.000 pcs

**Product Code**

A
CT84SN

**INTERKON**

**WIRE TO BOARD SHROUDED HEADER**

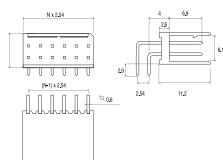
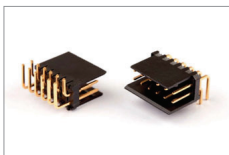

**Features** Polarized header with friction lock  
Pitch 2.54 mm

**Material** Insulator:  
Black thermoplastic GF UL 94V0  
Contact: Phosphor bronze

**Electrical** Current rating: 4 A maxi  
Dielectric withstanding: 500 V AC  
Insulation resistance: 1000 MΩ mini

**Mechanical** Temperature rating:  
-40 °C to 125 °C

**Packaging** Recyclable cardboard boxes

**Product Code**

A	B	C	D	E	F
476	2075	1	xx	4x0	-1

**D** Number of contacts from 04 to 26

**E** Plating  
0 Gold: 0.2 μm over Ni 1.27 μm  
4 Tin 4 μm over Ni 1.27 μm  
7 Selective Gold 0.2 μm over Ni 1.27 μm  
Other platings on demand.

**BS95**

**WIRE TO BOARD HOUSING**

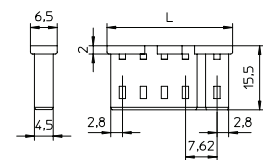

**Features** Single row housing, use with cr84 contact mates with CFM 5.06 Header

**Material** PPO UL94V1  
Gray colour

**Electrical** Voltage 320V

**Mechanical** Temperature rating: -30 °C to 85 °C

**Product Code**

A	B	C
BS95	/x	GR

**B** Number of contacts from 02 to 08

- 2A L=15.1
- 3A L=20.2
- 4A L=25.3
- 5A L=30.4
- 6A L=35.5
- 7A L=40.5
- 8A L=45.6

