

INDICO D44 / D44 INDICO 145 / INDICO 145-LWEB LED / D44K/P1-LWNEB-AL

Product Info



Item code	INDICO D44 / D44K/P1-LWNEB-AL
Category	Walk-over
Environments	urban landscape, façades and architectural works, wellness, hallway, conference hall, places of worship, residential lighting
Mounting type	with rough-in housing
Mounting note	On normally inflammable surfaces allowed.
Body	Corrosion resistant die-cast aluminium body and dome.
Painting	Polyester powder coating, with a pluri-processed against corrosion (passed the exposure of over 1500 hours in a saline mist environment).
Screws	AISI 304 stainless steel screws.
Seals	Silicone Rubber.
Static load	2000Kg
Standard Colour	AL aluminium grey
Option colors	GR graphite satin finish



Dimensions

Weight (kg)	1.2
D: Total diameter device (mm)	145
Volume piece packed (m³)	5

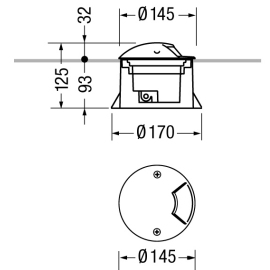

Included Accessories

Rough-in housing	Ground and Wall rough-in housing box, high impact resistant composite technopolymer (Code PT0719).
-------------------------	--

Optical System

Diffuser	Unbreakable UV-resistant polycarbonate.
Beam	ellittical
Emission	direct
Adjustable	Yes

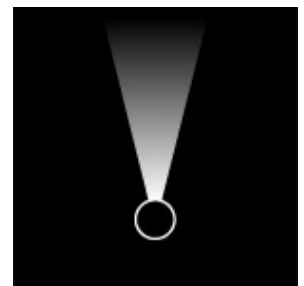

Photometrics

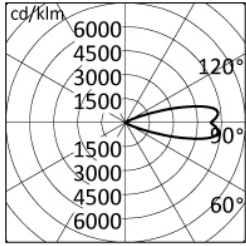

h (m)	∅ (m)	— $\gamma=0.0$ $\alpha=13^\circ$	∅ (m)	- - - $\gamma=0.0$ $\beta=43^\circ$	Emed (lx)
5.00	1.29		3.91		20
4.00	1.03		3.13		32
3.00	0.77		2.35		57
2.00	0.52		1.57		128
1.00	0.26		0.78		511

Sources

MacAdam	Step 3
Output Flux	104 lm
Source type	LED
System power	4,4W
Temperature Colour	4000K CRI>80

Electrical

Ballast type	ON-OFF.
Frequency	50-60Hz
Lifetime	60.000h L90B10 (Ta=25°C)
Line input	Pre-wired and tested with resin sealed watertight H07RN-F - H05RN-F (tellux/P01 model) cable (for a fast and secure connection to the main power line, use ACS/CR1 connector or similar).
Mounting ballast type	Integral
Voltage	220-240V
Separate ignition	No
Emergency 1E	No
Emergency 3E	No

Optional Accessories

Electrical

**ACS/CR1**

Fast IP68 connector 1bar (10m-1h) for cable Ø7-12mm - 3x1.5mm.

**ACS/CR6**

4 ways IP68 wiring box for cable Ø5-14mm - 3x1,5mm.